

KONTAKT 40/ K



- The KONTAKT 40/K has a high performance, small dimensions and regulated air system. It's opening new possibilities in professional and commercial use.
- This cooler is equipped with a completely unique high quality system with a quiet inbuilt compressor comprising a damper and molecule suction air filter.
- This cooler has a continuous cooling capacity of 35-40l/h., Max. 50l/h.
- The modern compressor cooling unit uses the power input for direct transfer to chilling, which guarantees minimum energy usage.
- Excellent chilled beer will be ready in the thermo block within 5-8 minutes after the cooler has been switched on.
- LINDR cooling technology is 45% more efficient than its power input.







- All external construction is made from stainless steel to give a more clean and aesthetic look.
- The materials used meet the highest requirements for hygiene standards and guarantee a long working life of this cooler.
- This machine comes with a stainless steel drip tray and an adjustable temperature control with 7 different settings.
- Two grab handles on top of the machine enables the machine to be carried and moved with ease.
- KONTAKT coolers have been recognised by experts findings as the beer coolers with the best ratio of price/ performance/ quality/ dimension.

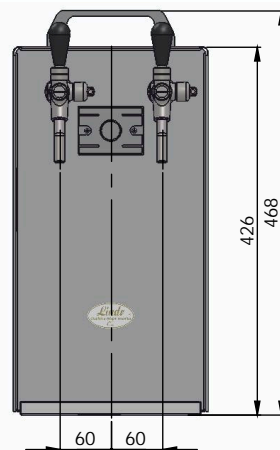
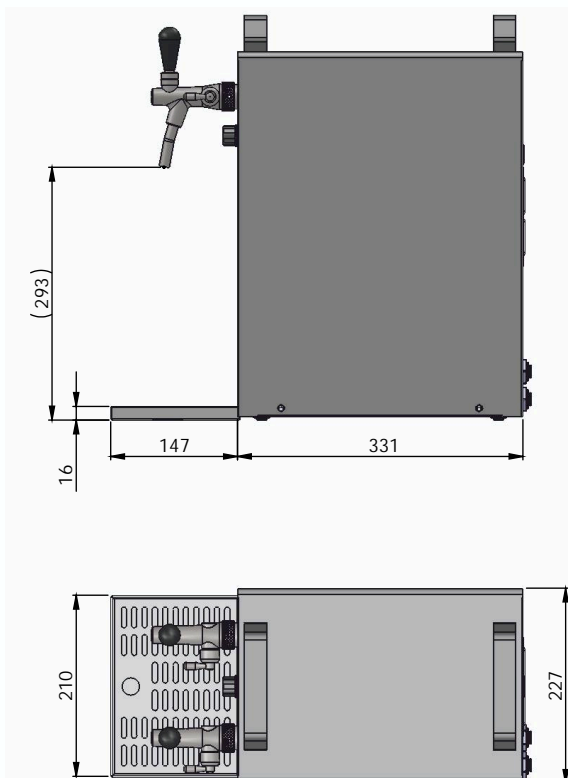

INBUILT AIR COMPRESSOR

2.7 bar

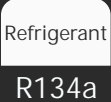

-  50 l/h
-  HP 1/5
-  AIR YES
-  Kg 29.3 Kg
-  2
-  Refrigerant R134a
-  2x 14.0 m